

E' SEVERAMENTE PROIBITA LA RIPRODUZIONE DI TUTTO O PARTE DEL PRESENTE DOCUMENTO, PREVIA AUTORIZZAZIONE DI DE FAVERI s.r.l.



Collegamento elettrico

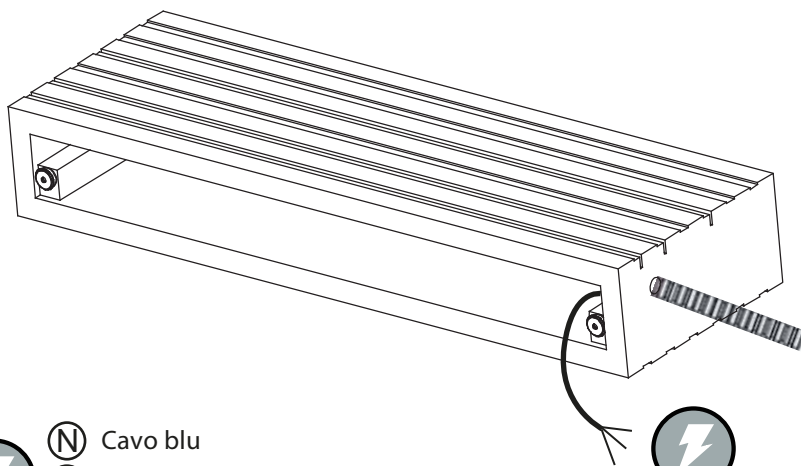

Scollegare l'alimentazione

Tensione di alimentazione
110 - 230 V~
50 - 60 Hz



-  (N) Cavo blu
-  Cavo giallo-verde
-  Cavo marrone



Predisporre una scorta di cavo di 15/20 cm

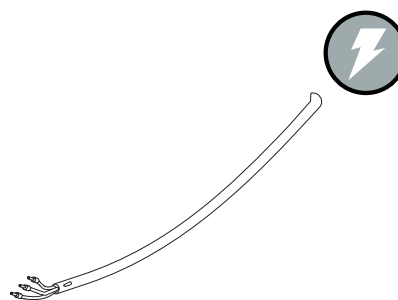
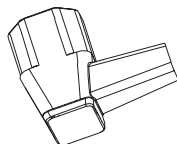

Collegare il connettore cavo di alimentazione